



APA SHOULD APPLY CONSERVATION DESIGN . . . AND **STOP FRAGMENTING** THE ADIRONDACK PARK'S FORESTED PRIVATE LANDSCAPES

The NYS Adirondack Park Agency approved New York Land & Lakes' subdivision at Woodworth Lake in January 2015.

This project carves up 1,100 acres of "Resource Management" land adjacent to the NY State Forest Preserve.

A Boy Scout camp's forests and shorelines will be permanently divided and developed into 24 residences and guest cottages, spreading damaging impacts across this tract and beyond it.

UNFRAGMENTED



Woodworth Lake tract, formerly owned by the Boy Scouts, as it appears today

FRAGMENTED

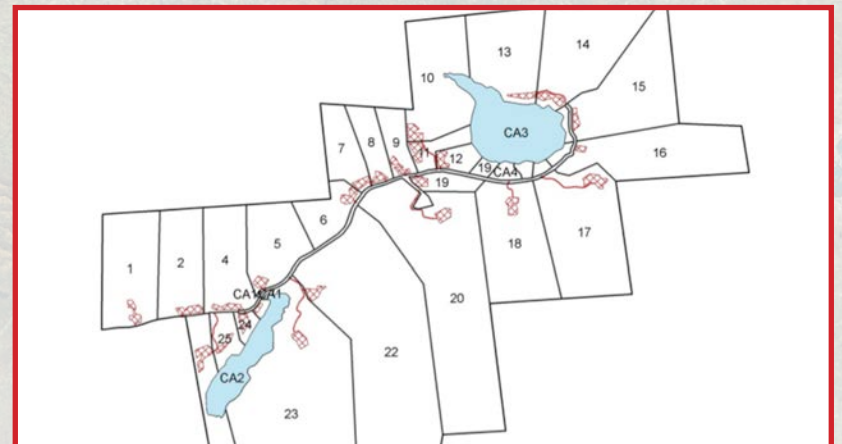

Woodworth Lake tract as it will appear under the APA permit

CONSERVATION DESIGN OF SUBDIVISIONS IN THE ADIRONDACKS SHOULD:

- Conduct ecological inventory and assessment over the course of one year (at least);
- Identify conservation zones and objectives, including sensitive wildlife habitats;
- Avoid impacts to those areas;
- Ensure conservation of contiguous open space for hunting, fishing, forestry, agriculture;
- Concentrate development near existing infrastructure, reducing development costs;
- Design lot lines and building footprints only as a final step.

Completing these steps will help preserve the integrity of the Park's landscapes.

This sequence of steps was not taken at Woodworth Lake.

THE APA CAN DO MUCH BETTER THAN THIS.

Please join Adirondack Wild in its efforts to persuade Governor Andrew Cuomo and the APA to require conservation design, and end fragmentation of the Park's private lands due to damaging subdivisions like this one.

To become a member, make a donation, or to sign up for our free newsletter, please visit our website.

WE'RE ON THE WILD'S SIDE...

SAFEGUARDING THE WILD | EXTENDING THE WILD | EDUCATING FOR THE WILD

WWW.ADIRONDACKWILD.ORG

Founded 1945